

**PRICE  
REDUCTION**



**FOR SUBLEASE**

# 511 David Street

Units C & D | Victoria, BC

**5,850 SF INDUSTRIAL OPPORTUNITY IN ROCK BAY**

**CBRE**



# 511 David Street

## SPACE FEATURES

- + 5,850 SF including mezzanine
- + Reception/warehouse/3 private office on the mezzanine
- + Skylights in warehouse
- + Equipped with alarm system and cameras

**\$16.00**

SUBLEASE RATE PSF

**\$7.50**

ADDITIONAL RENT PSF

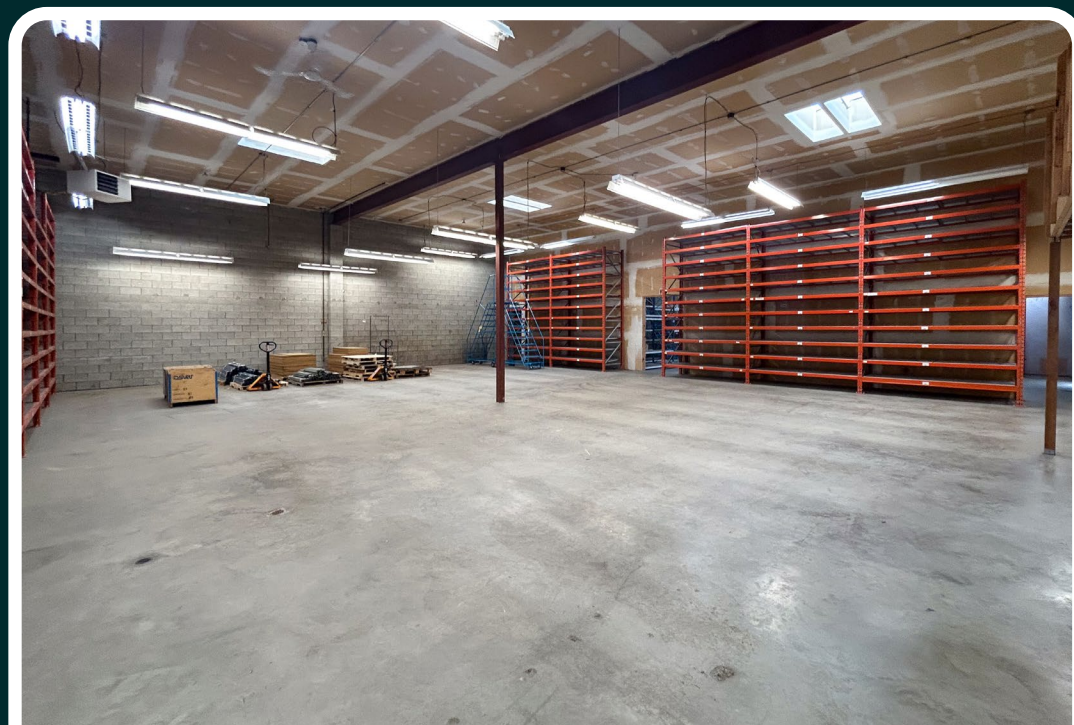

## Industrial | For Sublease

CBRE Victoria is pleased to present the opportunity to sublease turnkey warehouse and office space located at 511 David Street in the Rock Bay Industrial hub, just outside downtown Victoria. The premises offers 5,850 square feet across Units C and D, including 500 square feet of mezzanine space, a reception area, three offices, two washrooms, and two 8'x8' grade-level loading doors. Warehouse racking can be included. M-2 Light Industrial District zoning accommodates a broad range of business uses.

<b>Size</b>	5,850 SF (includes 500 SF Mezzanine)
<b>Loading</b>	Two 8'x8' grade level loading doors
<b>Ceiling</b>	18' clear heights
<b>Power</b>	200-amp 3 phase power
<b>Heating</b>	Electric baseboard in offices & overhead gas in warehouse
<b>Parking</b>	3 on-site surface parking stalls
<b>Zoning</b>	M-2 Light Industrial District
<b>Availability</b>	Immediately
<b>Sublease Term</b>	Until January 31, 2029

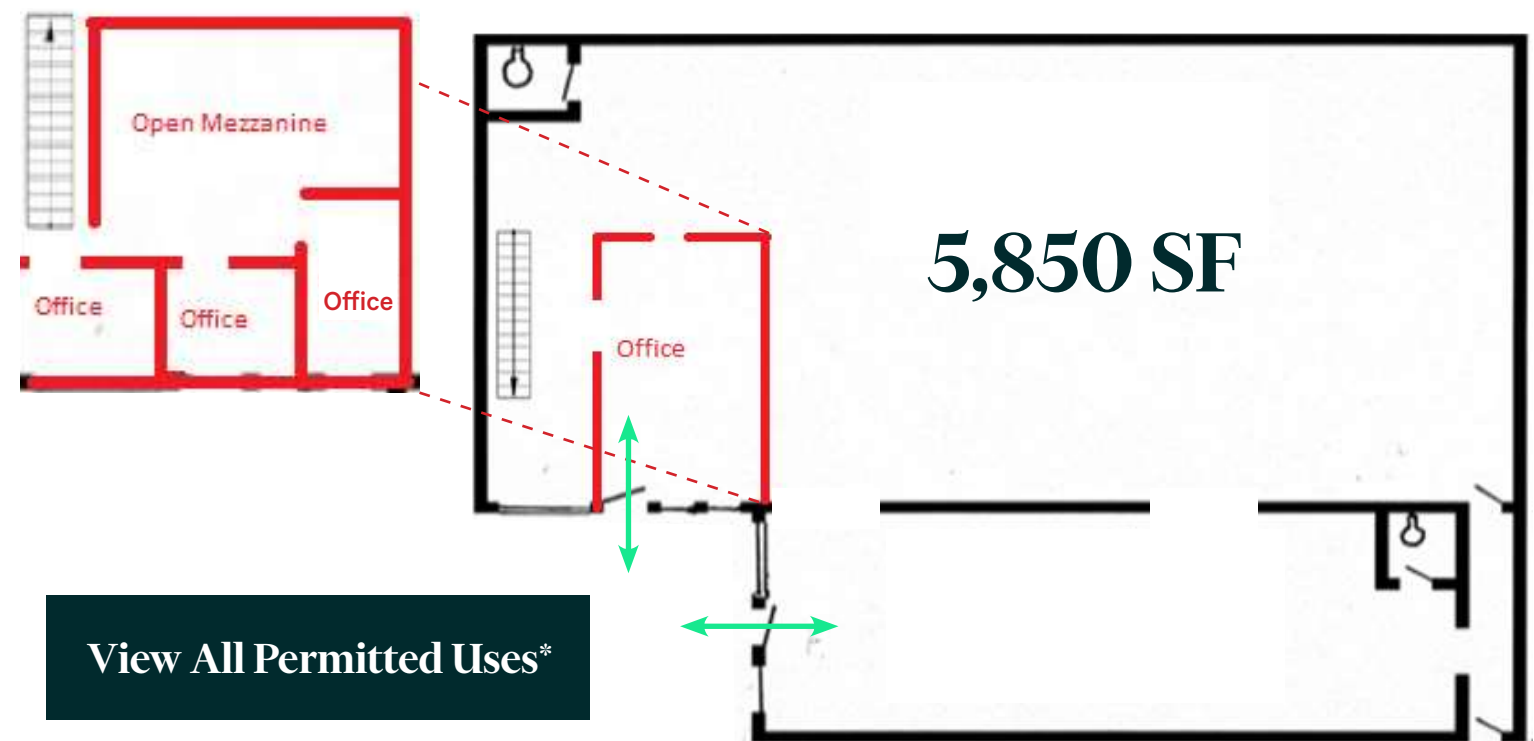

[View All Permitted Uses\\*](#)

\*End user subject to landlord approval.

**FOR SUBLEASE**

**CBRE**

# 511 David Street

Units C & D | Victoria, BC



**5,850 SF INDUSTRIAL OPPORTUNITY IN ROCK BAY**

## CONTACT US

### Andrea Teahen

Senior Associate  
andrea.teahen@cbre.com  
250 813 3377

### Ross Marshall

Personal Real Estate Corporation  
Senior Vice President  
ross.marshall@cbre.com  
250 386 0004

### Cooper Anderson

Associate  
cooper.anderson@cbre.com  
250 386 0276

CBRE Limited | [www.cbrevictoria.com](http://www.cbrevictoria.com) | 110-800 Yates Street, Victoria, BC, V8W 1L8 | 250 386 0000

This disclaimer shall apply to CBRE Limited, Real Estate Brokerage, and to all other divisions of the Corporation; to include all employees and independent contractors ("CBRE"). The information set out herein, including, without limitation, any projections, images, opinions, assumptions and estimates obtained from third parties (the "Information") has not been verified by CBRE, and CBRE does not represent, warrant or guarantee the accuracy, correctness and completeness of the Information. CBRE does not accept or assume any responsibility or liability, direct or consequential, for the Information or the recipient's reliance upon the Information. The recipient of the Information should take such steps as the recipient may deem necessary to verify the Information prior to placing any reliance upon the Information. The Information may change and any property described in the Information may be withdrawn from the market at any time without notice or obligation to the recipient from CBRE. Content contained in this material has been generated in whole or in part by or with the assistance of generative artificial intelligence. CBRE and the CBRE logo are the service marks of CBRE Limited and/or its affiliated or related companies in other countries. All other marks displayed on this document are the property of their respective owners. All Rights Reserved. Mapping Sources: Canadian Mapping Services [canadamapping@cbre.com](mailto:canadamapping@cbre.com); DMTI Spatial, Envirionics Analytics, Microsoft Bing, Google Earth.